

Box Properties

--Description--

Name: W3-2088SOF

Type: Passive Radiator Box

Shape: Prism, square

--Box Parameters--

Vb = 2.5 liters

V(total) = 2.706 liters

QL = 7

F3 = 37.32 Hz

Fill = minimal

--Passive Radiators--

No. of Passive Radiators = 1

Fs = 7.824 Hz

Qms = 2.911

Vas = 47.22 liters

Cms = 5.911 mm/N

Mms = 70 g

Rms = 1.182 kg/s

Sd = 75 sq.cm

Driver Properties

--Description--

Name: W3-2088SOF

Type: Standard one-way driver

--Configuration--

No. of Drivers = 1

--Driver Parameters--

Fs = 43 Hz

Qms = 4.1

Vas = 2.1 liters

Xmax = 6.85 mm

Sd = 44 sq.cm

Qes = 0.546

Re = 3.6 ohms

Le = 0.182 mH

Z = 4 ohms

Pe = 25 watts

Wiring Diagram

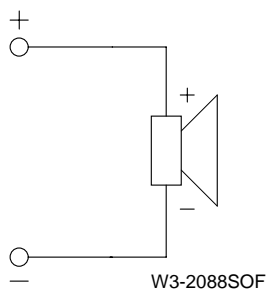

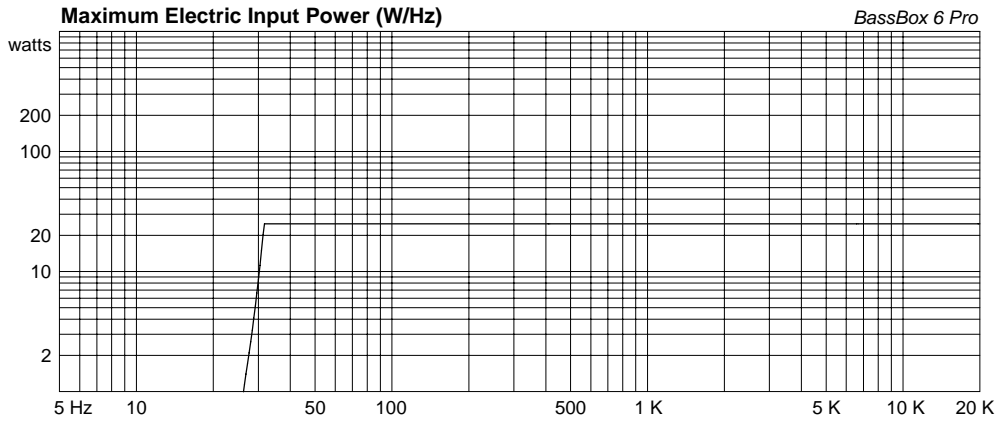
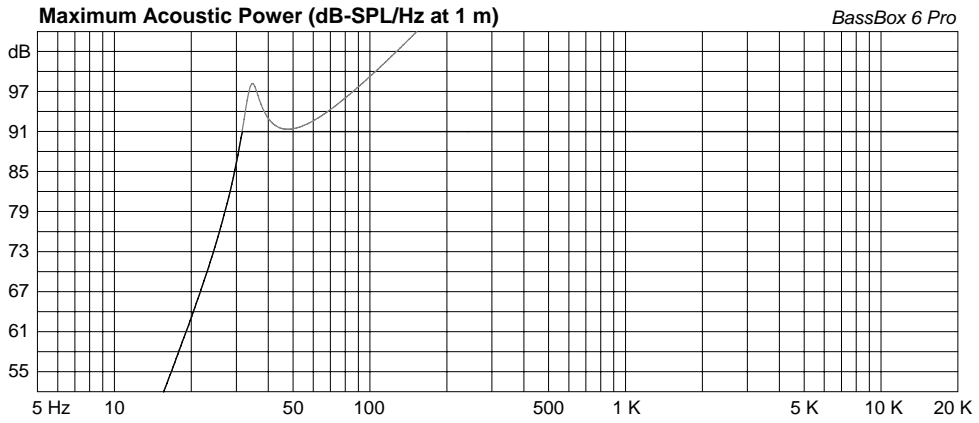
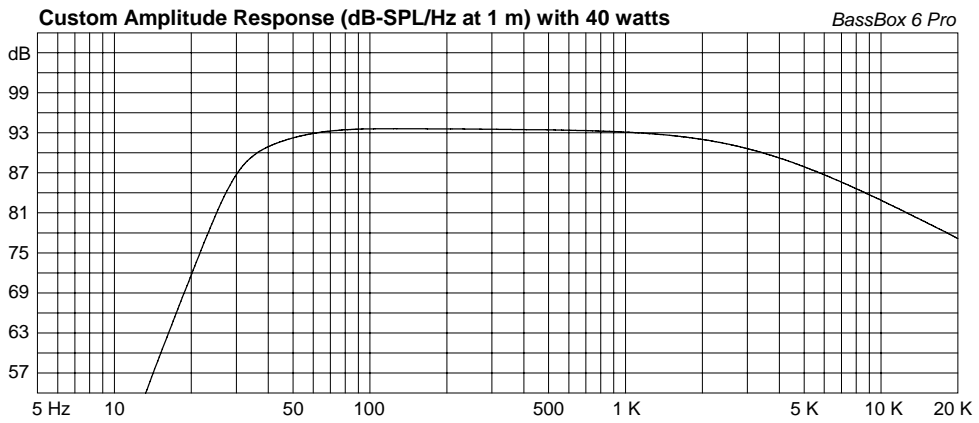
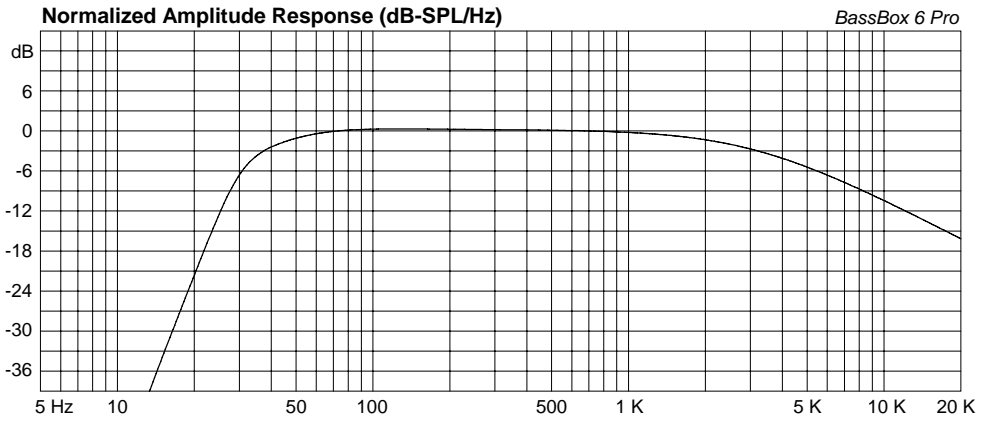

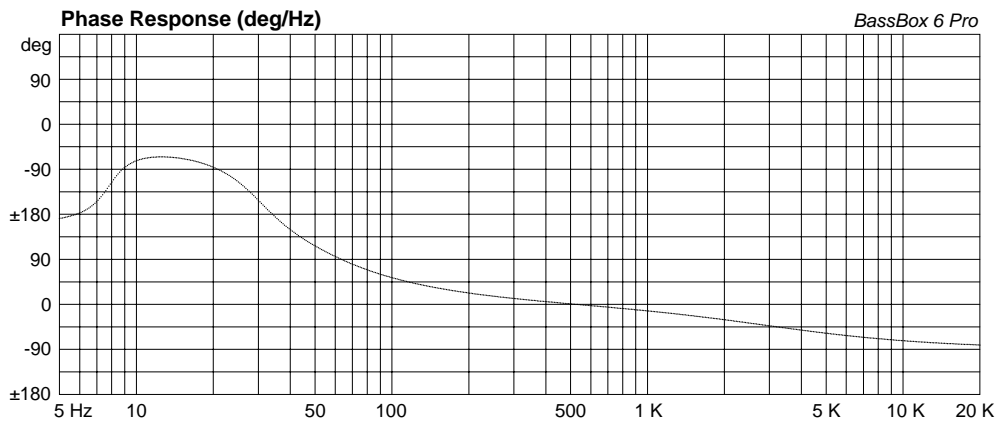
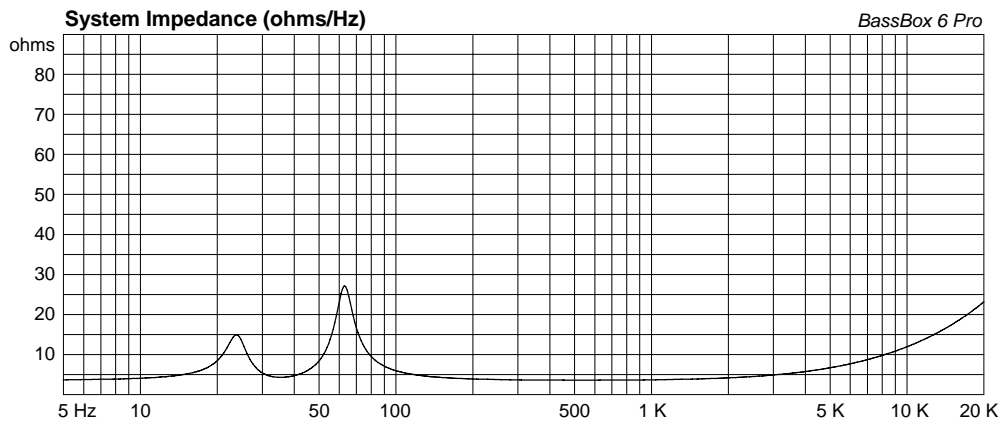
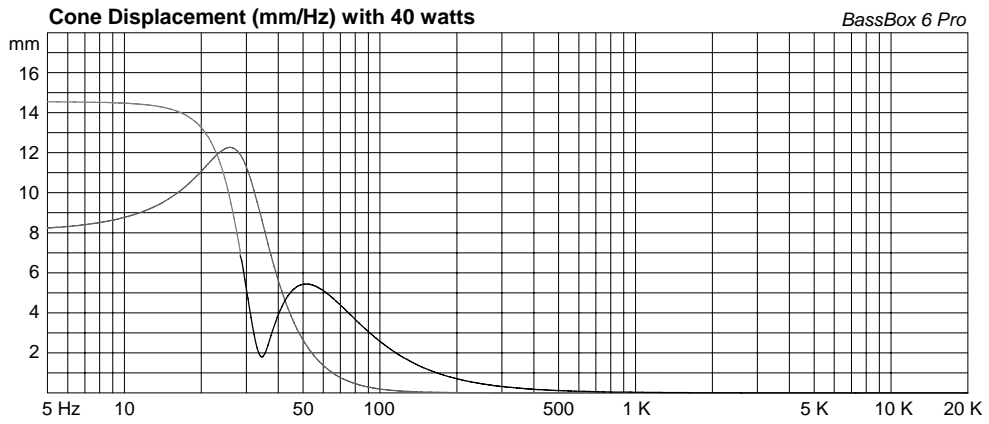

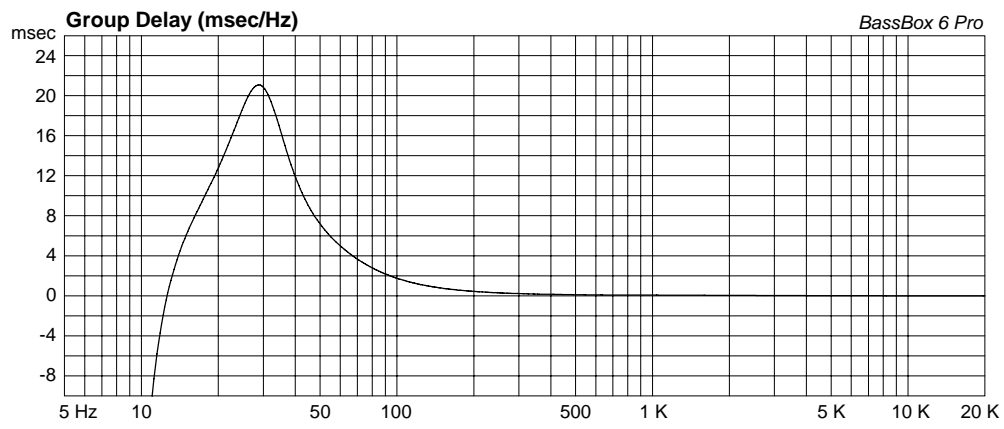

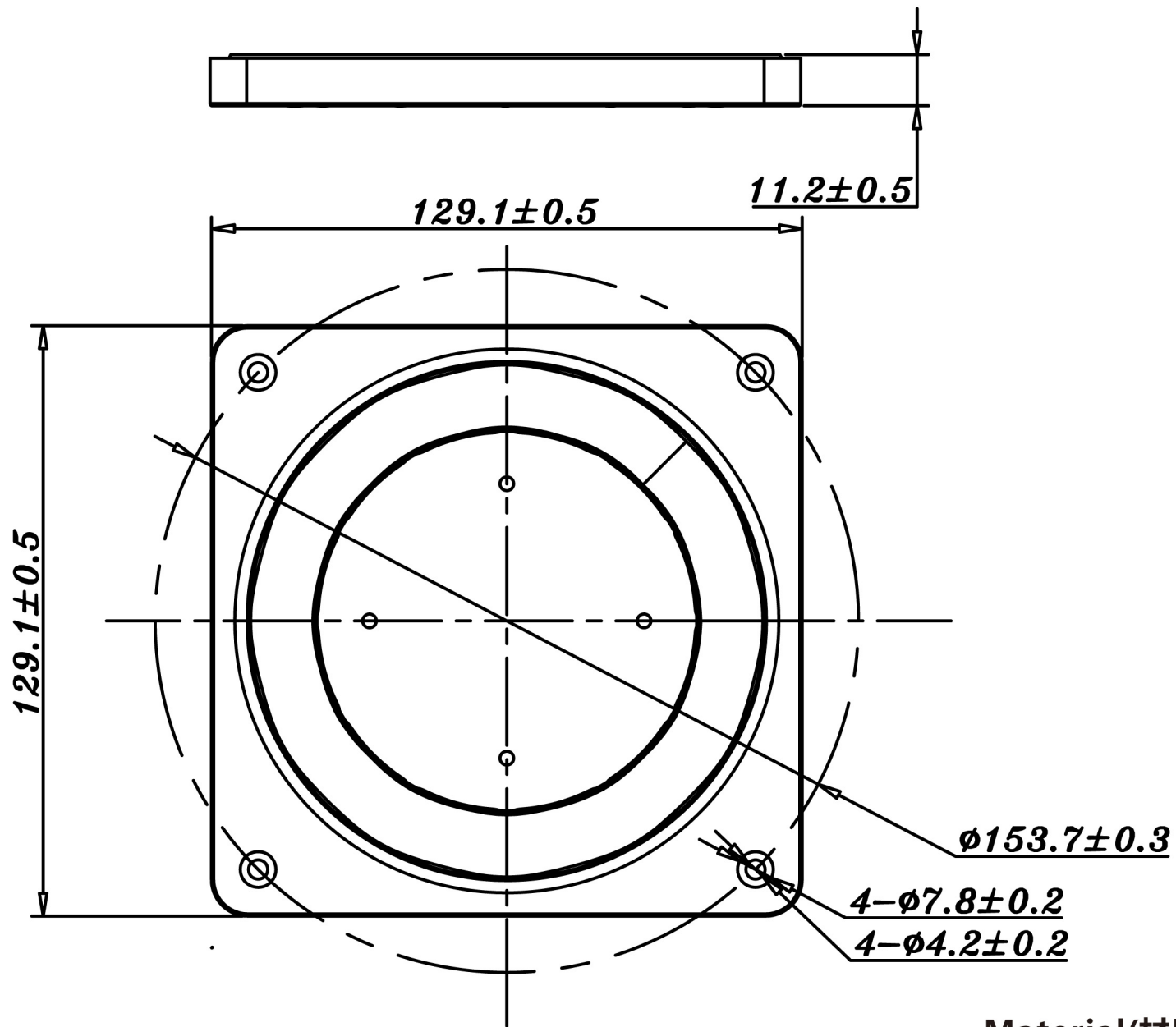

Material(材质):Rubber



PR13

Rev:R01

Date : 2015-09-07